

Features

- 600 V at 105°C maximum electrical rating
- Made from brass with a colour coded nylon insulation
- Provides simple and time saving wire connection method



Specification

Wire Range (mm ²)	0.5 ... 0.75 mm ²
Wire Range (AWG)	22 ... 18 AWG
Voltage Rating	600 V
Termination Method	Splice
Length	37 mm
Width	9.3 mm
Terminal Thickness	0.8 mm
Insulation Colour	Red
Insulation Material	Nylon
Terminal Material	Brass
Terminal Surface Treatment	Tin Plated

Drawing

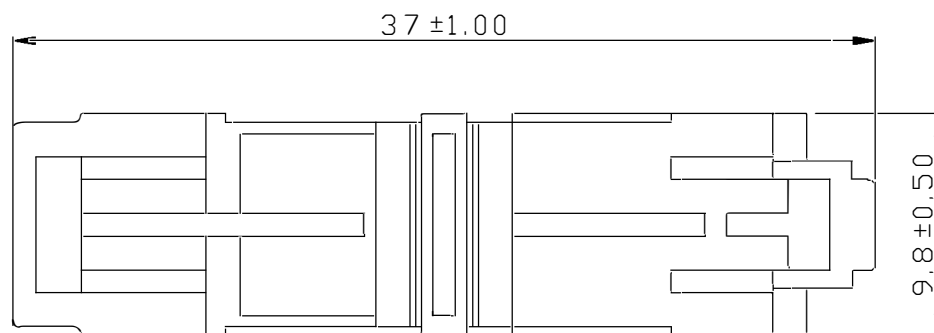

Art. Nr.
RND 465-00051